

How robots are helping to map out the future for the NHS by supporting hospital staff

Paul Jenkins – AGM Facilities



Exceptional healthcare, personally delivered



Why we introduced robots into Southmead Hospital

- **Thinking differently**
- **New build opportunity**
- **Manual handling**
- **Time constraints**
- **Distances to be covered**
- **Minimise damage to the building**
- **Dedicated 'Send' and 'Receive' hubs**

GF

L1

L2

L3

L4

L5

L6

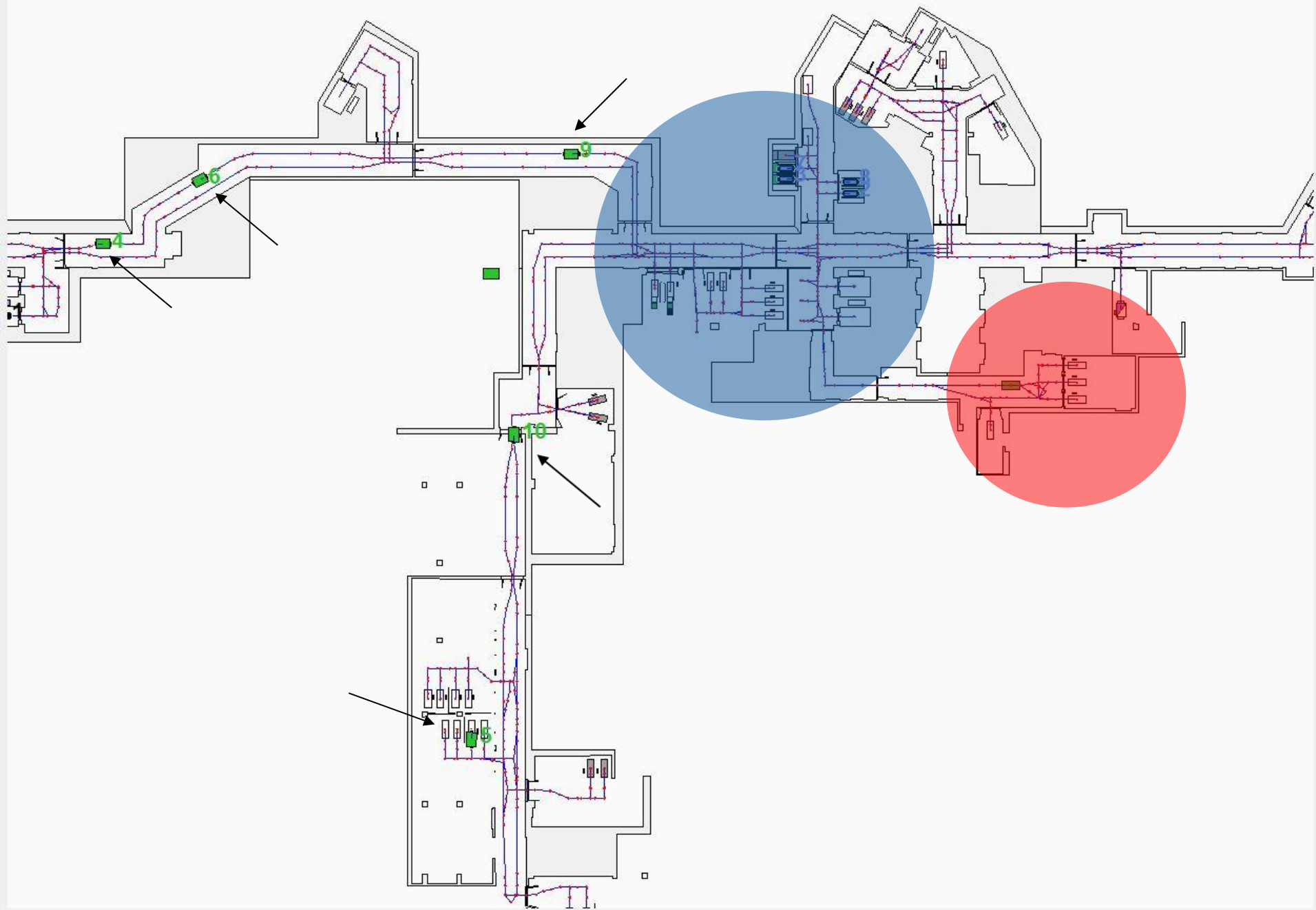

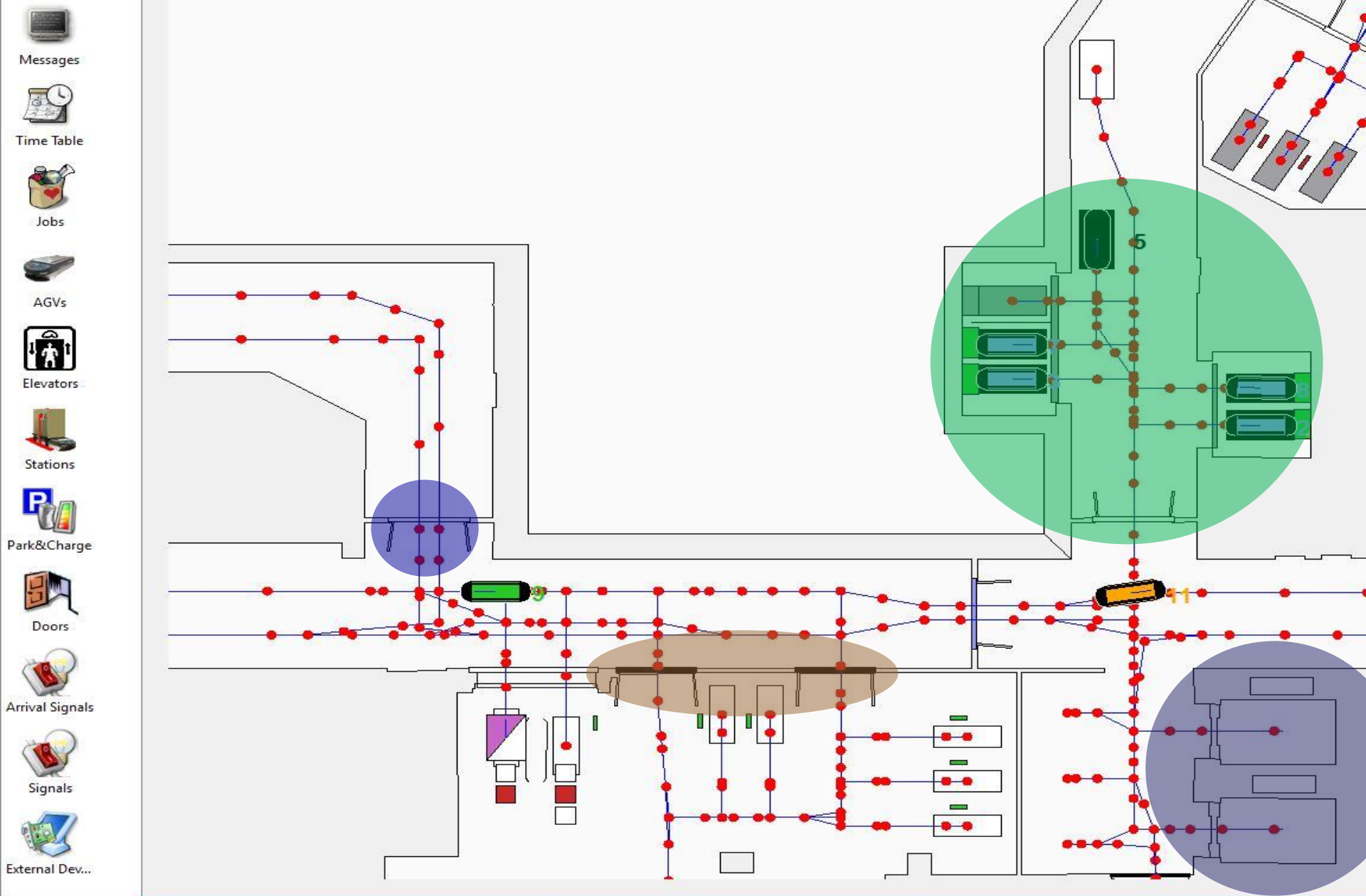

System	Error Messages
Time: 09:42:37	<2018-11-16 09:39:32.001> E External Unit Device 'SHB.PLC.P2.CR1': device error.
State: Running	<2018-11-16 09:39:32.003> E External Unit Device 'SHB.PLC.P2.CS1': device error.
#AGVs: 8	
#Carts: 21	
#Jobs: 5	
#Today: 104	

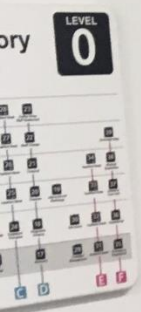

Gate
4
Decontamination
Facility



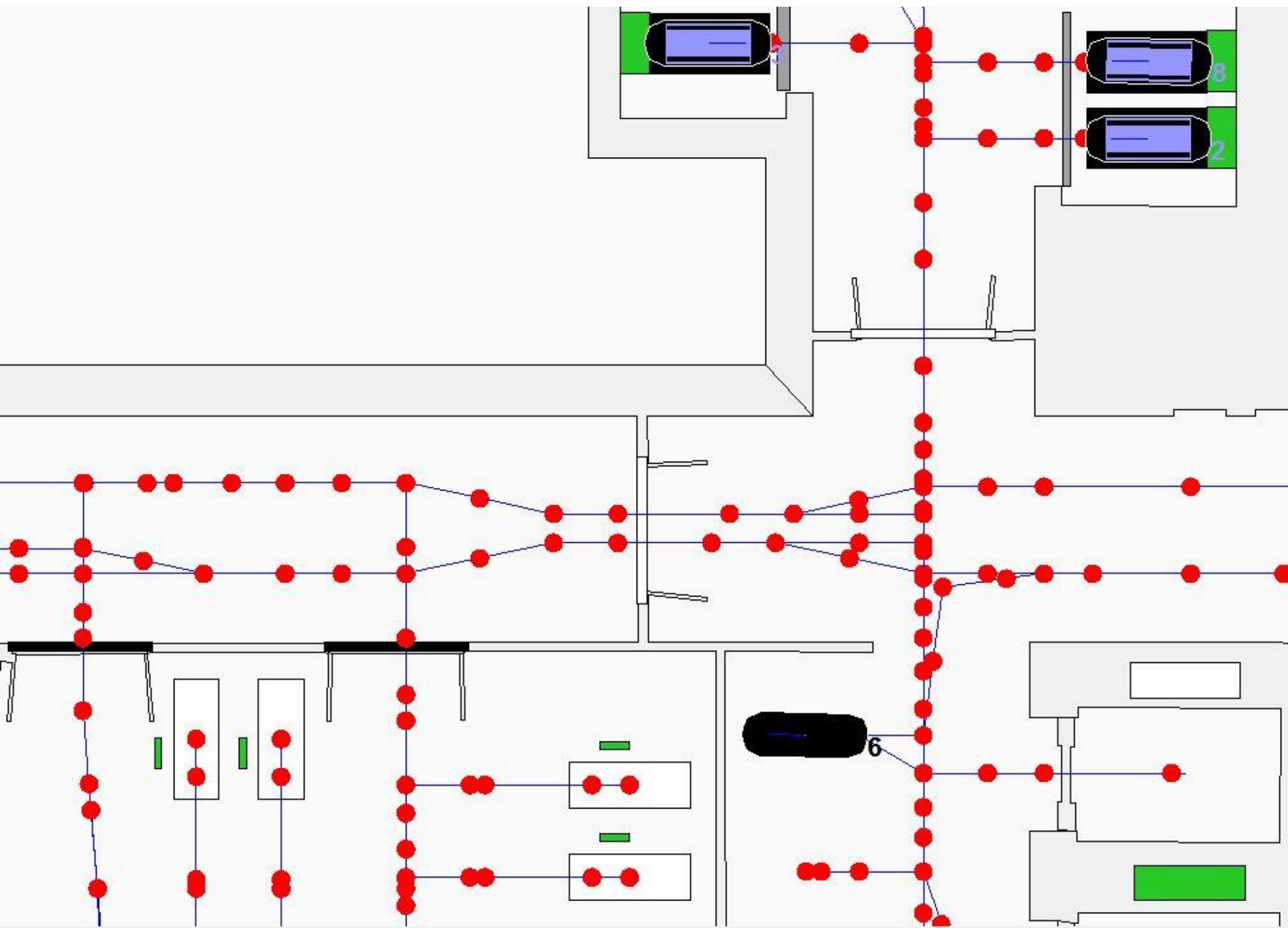



Gate Directory

LEVEL 0	
6	AGV
5	AGV
4	AGV
3	AGV
2	AGV
1	AGV
0	AGV



What our Automatic Guided Vehicles (AGV's) can do

They can be scheduled or called on demand to carry:

- **Linen**
- **Sterile Services**
- **Catering**
- **Pharmacy**
- **Materials Management**
- **Waste**

But never people!



Job Id	Battery Value
779887	<div><div></div></div> 49%
0	<div><div></div></div> 100%
0	<div><div></div></div> 100%
0	<div><div></div></div> 62%
779890	<div><div></div></div> 46%
779891	<div><div></div></div> 62%
0	<div><div></div></div> 57%
0	<div><div></div></div> 90%
779892	<div><div></div></div> 47%
779884	<div><div></div></div> 48%
0	<div><div></div></div> 50%
779889	<div><div></div></div> 33%

Agvs							Current Node
Id	Host	State	Electronic State	Mode	Tcms2 State		
1	tc1	Halt	Charge	Autom...	To Charger		GF.C.CP_PP.CP5.Charger.Or
2	tc2	Confirmed Er...	On	Autom...	Normal		GF.W.X8.TG1.fromF12_10
3	tc3	Halt	On	Autom...	Reserved		GF.C.Kitchen.WL.Place1
4	tc4	Action	On	Autom...	Normal		L3.Core11.3Q-DP3(TH2).R1
5	tc5	Halt	On	Autom...	Normal		GF.C.DomesticWaste.XR.toF
6	tc6	Action	On	Autom...	Normal		GF.C.P2-D31.fromR_D_2a
7	tc7	Halt	Charge	Autom...	To Charger		GF.C.CP_PP.CP2.Charger.Or
8	tc8	Pre Action	On	Autom...	Normal		Lift.LG4_5.F4.Cabin.InBSOu
9	tc9	Halt	On	Autom...	Normal		GF.W.toCentral_51
10	tc10	Action	On	Autom...	Reserved		GF.W.AF6.X.toF6_14
11	tc11	Halt	Charge	Autom...	Battery L...		GF.E.CP_PP.CP6.Charger.On
12	tc12	Halt	Charge	Autom...	Battery L...		GF.C.CP_PP.CP4.Charger.Or

	Job Id	State	Type	Source	Target	Alternative Target	Appearance	Priority	Pick Up	Arrival	Agv	Cart Type
1	779890	Transport	Transp...	L4.Core11.4G-DP3.SR3.S	GF.C.DomesticWaste.Return.R...		09:48:35	+00:00:00	09:52:04	10:01:37	5	DomesticWaste
2	779892	Transport	Transp...	L2.Core1.2A-HUB1.SR2.S	GF.C.Conveyor.R1.R		09:49:01	+00:00:00	09:59:24	10:09:09	9	StockItems-NHS_Supply...
3	779893	Fetch Reserv...	Transp...	GF.C.RandD.SR.5.S	L3.Core11.3Q-DP3(TH2).R1.R		09:53:36	+00:00:00	00:00:00		4	CleanLinen
4	779895	Fetch	Transp...	L3.Core9.3P-DP2(TH1).SR2.S	GF.C.Conveyor.R1.R		09:53:56	+00:00:00	00:00:00		8	StockItems-NHS_Supply...
5	779896	Waiting	Transp...	L2.Core9.2N-DP2(TH1).SR...	GF.C.Conveyor.R1.R		09:54:22	+00:00:00	00:00:00		10	StockItems-NHS_Supply...
6	779897	Fetch	Transp...	GF.C.RandD.SR.4.S	L3.Core9.3P-DP2(TH1).R1.R		09:54:28	+00:00:00	00:00:00		10	NonStockItems-NHRP
7	779898	Fetch	Transp...	L1.Core4.1L-RENAL-W2.S...	GF.C.DomesticWaste.Return.R...		09:54:43	+00:00:00	00:00:00		2	DomesticWaste

The benefits achieved to date

- **Reduced manual handling**
 - **More time for patient logistics**
 - **Minimise damage to the building**
 - **Time bound food delivery**
 - **Reduced delivery location errors**
 - **Workforce duties realignment**
 - **Clear corridors**
 - **Easy expansion / increase of activity**
-

Total Jobs Completed Per Month

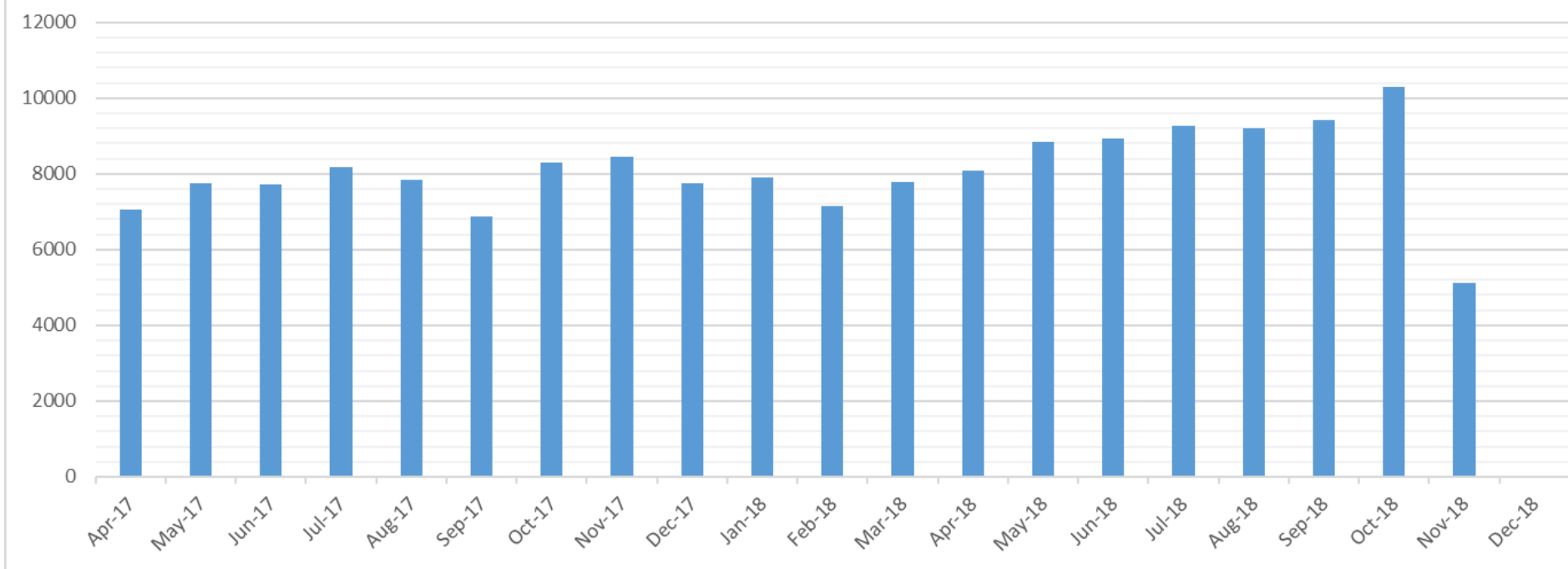



Lessons learned

- **Culture and acceptance**
 - **Education / training**
 - **Information Technology**
 - **Maximum capacity**
 - **Responsibilities, who does what?**
 - **Who has priority?**
 - **The disappearing card**
 - **Other robots!**
-

Thank you for listening

paul.jenkins@nbt.nhs.uk